

LED PERFORMANCE DAMPPROOF G3 EMERGENCY

كشاف ليد مقاوم للرطوبة

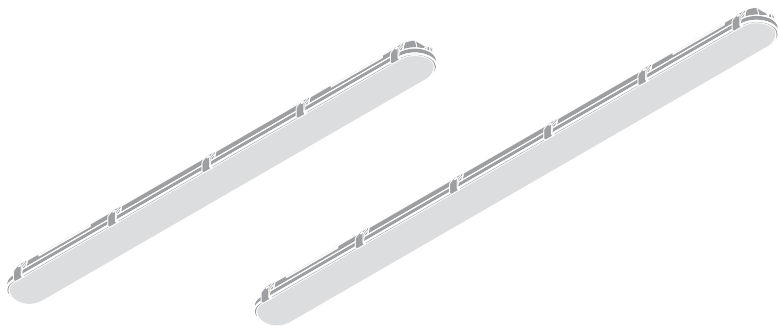



	Model number	L x W x H (mm)	W	V _{AC}	Hz	K	IP	IK	Beam angle	Operating Temp.	PF	
Dampproof 1200 18W Emergency	P-DP12-18W-EM-G3-865	1200x77x68	18W	220-240V	50/60 Hz	6500	65	08	120°	0°C~+35°C	0.9	1582g
Dampproof 1500 26W Emergency	P-DP15-26W-EM-G3-865	1500x77x68	26W	220-240V	50/60 Hz	6500	65	08	120°	0°C~+35°C	0.9	1842g
Dampproof 1200 35W Emergency	P-DP12-35W-EM-G3-865	1200x77x68	35W	220-240V	50/60 Hz	6500	65	08	120°	0°C~+35°C	0.9	1682g
Dampproof 1500 49W Emergency	P-DP15-49W-EM-G3-865	1500x77x68	49W	220-240V	50/60 Hz	6500	65	08	120°	0°C~+35°C	0.9	1942g
Dampproof 1200 18W Emergency	P-DP12-18W-EM-G3-840	1200x77x68	18W	220-240V	50/60 Hz	4000	65	08	120°	0°C~+35°C	0.9	1582g
Dampproof 1500 26W Emergency	P-DP15-26W-EM-G3-840	1500x77x68	26W	220-240V	50/60 Hz	4000	65	08	120°	0°C~+35°C	0.9	1842g
Dampproof 1200 35W Emergency	P-DP12-35W-EM-G3-840	1200x77x68	35W	220-240V	50/60 Hz	4000	65	08	120°	0°C~+35°C	0.9	1682g
Dampproof 1500 49W Emergency	P-DP15-49W-EM-G3-840	1500x77x68	49W	220-240V	50/60 Hz	4000	65	08	120°	0°C~+35°C	0.9	1942g

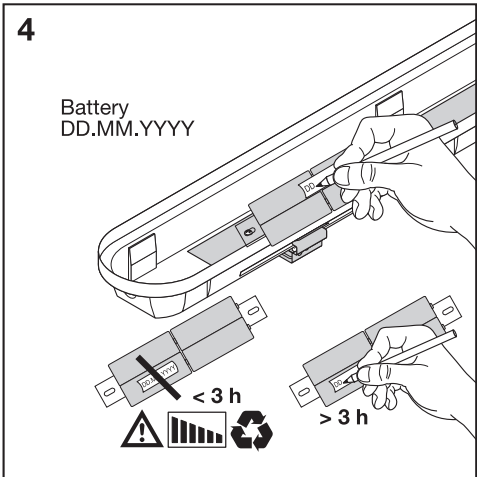
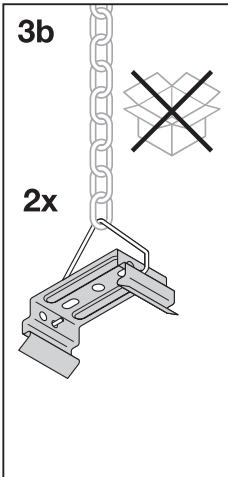
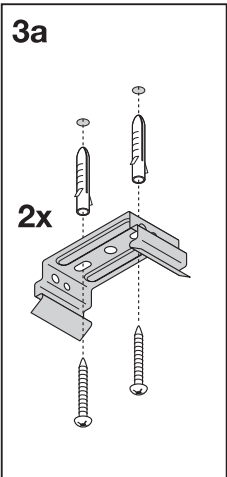
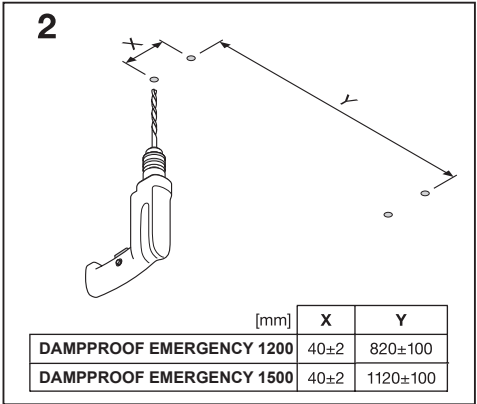
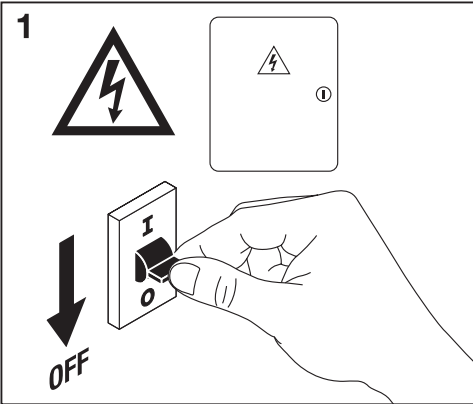
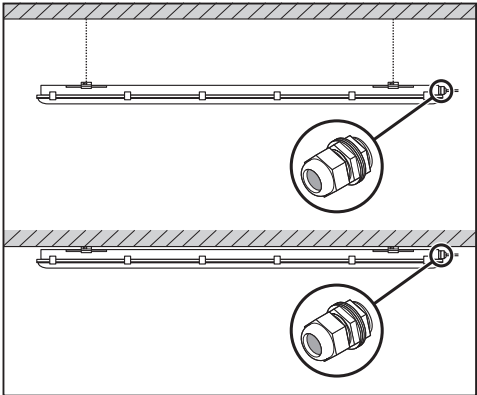
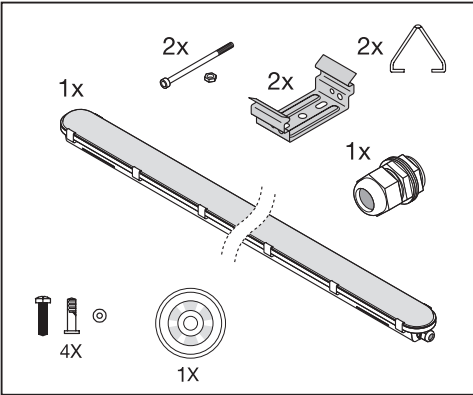

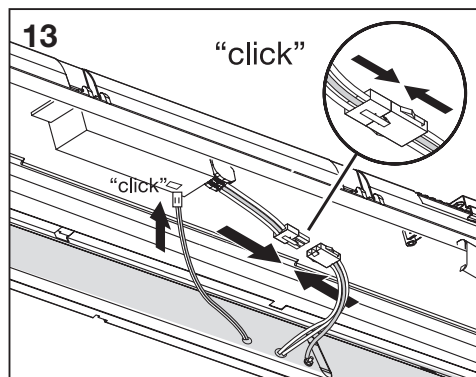
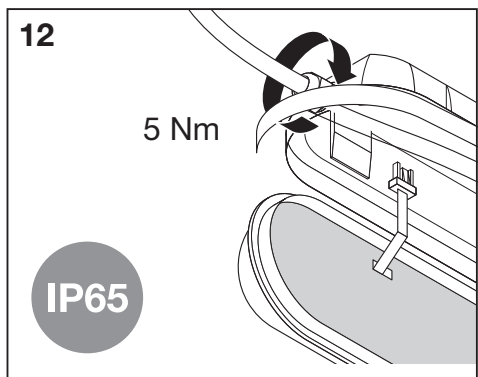
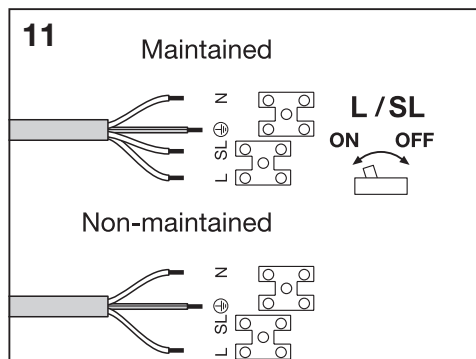
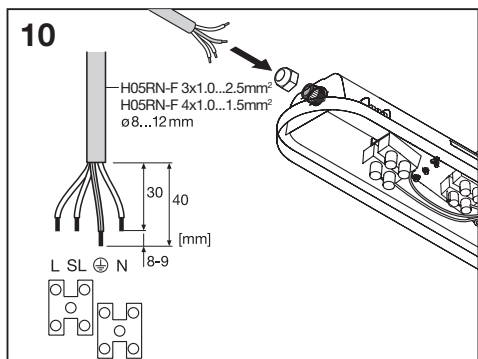
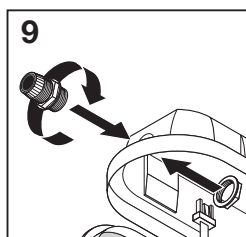
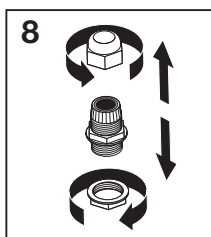
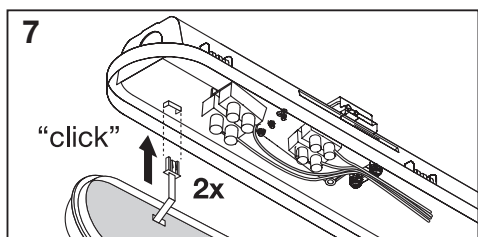
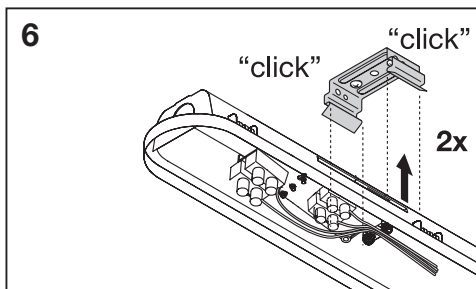
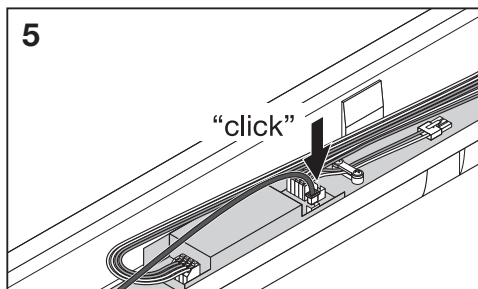

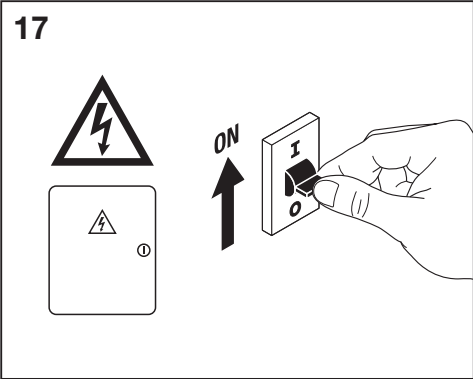
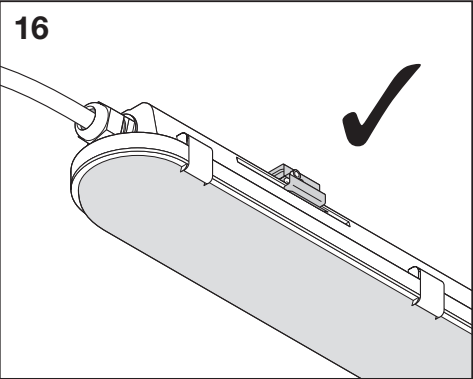
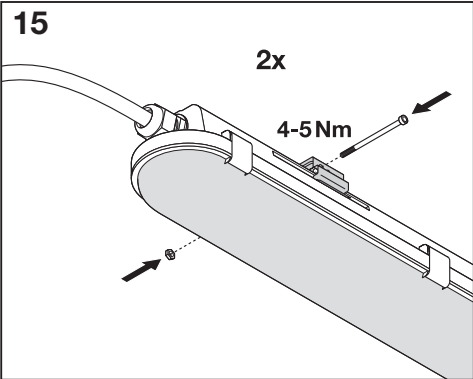
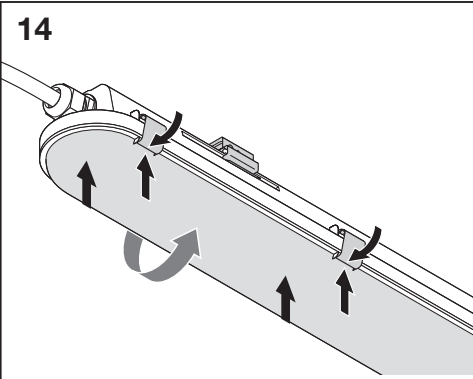

















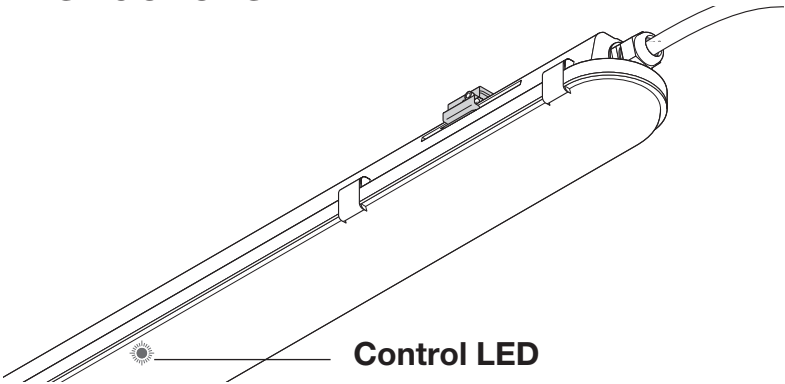

	 BATTERY	TEST	 lm
Dampproof 1200 18w Emergency	LiFePO4-3h	Automatic	600
Dampproof 1500 26w Emergency	LiFePO4-3h	Automatic	600
Dampproof 1200 35w Emergency	LiFePO4-3h	Automatic	600
Dampproof 1500 49w Emergency	LiFePO4-3h	Automatic	600

	 MAINTAINED / NON-MAINTAINED 
Dampproof 1200 18w Emergency	 Maintained / Non-maintained 
Dampproof 1500 26w Emergency	 Maintained / Non-maintained 
Dampproof 1200 35w Emergency	 Maintained / Non-maintained 
Dampproof 1500 49w Emergency	 Maintained / Non-maintained 

Test Instructions



LED indicator

	Green fast flash(0.1 second on, 1 second off), charging mode
	Green slow flash(0.1 second on, 6 second off), self test underway, including function test and duration test
	Green stable: battery fully charged
	Red flash, failure(including load failure, charging failure, battery failure)
	Green and red off, DC mode (battery operation, emergency mode)

Self-test:

- Status of the battery.
- Status of the LED.
- Charge condition.
- Duration test

Functional test

Connecting battery firstly, connecting mains supply then, this emergency conversion module will automatically go into self-test on charge circuit and discharge function as well as installation of led lamp within 3 seconds.

Timer starts to calculate based on led indicator turning into green when battery is fully charged for the very first time. The emergency conversion module will automatically discharge 10 seconds every 30 days as a short time functional test.

Duration test

Emergency conversion module will automatically discharge 90 minutes every 180 days to check percentage between discharge time and battery voltage and then evaluate battery capacity normal or not. If it's normal, emergency module will automatically go into next working cycle, otherwise led indicator would turn into red flashing.

The emergency pack should discharge over 180 minutes after fully charged during emergency mode, but it is set to discharge 90 minutes during duration self-test, after 90 minutes duration self-test, it will go into charging mode again.

If a mains supply failure occurs at any time, before or during functional test and duration test period, emergency conversion module will go into emergency mode immediately. Timer would not re-calculate if battery is not disconnected after emergency mode. If battery is disconnected, whole emergency conversion module will recover to initial status.

Attention

- To guarantee the rated discharge time, please charge the battery for more than 12 hours.
- Charge and discharge cycle needs to be done at least once every three months, and the continuous charging time can not exceed 3 months.

WARNING:

- The light source contained in this luminaire shall only be replaced by the manufacturer or his service agent or a similar qualified person.
- Connect to the power supply in accordance with national regulations. And make sure the power supply is off when connecting.
- This product is to be installed by a licensed electrician in strict accordance with local wiring rules.
- Please note that the fixture is equipped with standard surge protection only. To protect the fixture from sags, surges, and lighting strikes, additional surge protectors must be deployed on the primary side.

تحذير

- يجب استبدال مصدر الضوء الموجود في وحدة الإنارة فقط عن طريق المصنِّع أو وكيل الخدمة أو شخص مؤهل مماثل.
- قم بتوصيل التيار الكهربائي وفقاً للوائح الوطنية وتأكد من فصل التيار الكهربائي عند التوصيل.
- هذا المنتج يجب أن يتم تثبيته من قبل كهربائي مرخص وفقاً لقواعد التوصيل المحلية.
- ملاحظة: وحدة الإضاءة هذه مزودة بحماية من نبضات الفولتية اللحظية المرنعة حسب المواصفات المعتمدة عالمياً

LEDVANCE Pte Ltd.
988 Toa Payoh North, # 03-06,
Singapore 319002
LEDVANCE Sdn. Bhd. (1166537-U)
100.7.009, 129 Offices, Block J, Jaya One
No. 72A, Jalan Universiti,
46200 Petaling Jaya,
Selangor Darul Ehsan, Malaysia

(주)레드밴스
서울시 강남구 삼성로 554 예성빌딩 6층
(우편번호 06165)
전화번호: +82 80 4891 700
www.ledvance.co.kr
LEDVANCE Prosperity Co., Ltd.
20/F, Cornell Centre, 50 Wing Tai Rd.,
Chai Wan, Hong Kong

LEDVANCE Middle East FZE
Jebel Ali Free Zone
JAFZA 16, Office 603
P.O. Box 17476, Dubai – UAE

LEDVANCE Pvt. Ltd.
1201-1202, 12th Floor, Signature Towers, Tower-A,
South City-I, Gurugram - 122001, Haryana (India)
Consumer care (Name and address as per above),
Consumer care Tel. No. 0124-4150100
E-mail id: customercare@ledvance.com
www.ledvance.in

IP65 RoHS



C10449057
G11117323
2021-03-29

TIS. 1955-2551

www.ledvance.com